



*Expanding on Perfection*  
*ARIA East Convention Center*

Level Two Pre-Function Space

A major 200,000-square-foot expansion of our award-winning, technologically advanced convention center will be highlighted by stunning indoor/open-air spaces and a glass-enclosed venue with dramatic views of The Park and spectacular new T-Mobile® Arena.



## PLAZA

The plaza level will feature an open ballroom with ample pre-function spaces, and access to an exclusive loading dock for events that require sizable displays.

## PLAZA LEVEL

- Orovada Ballroom



## LEVEL ONE

Versatile indoor-outdoor breakout rooms which provide meetings flexibility to enjoy the Las Vegas weather while conducting business will highlight the first level.

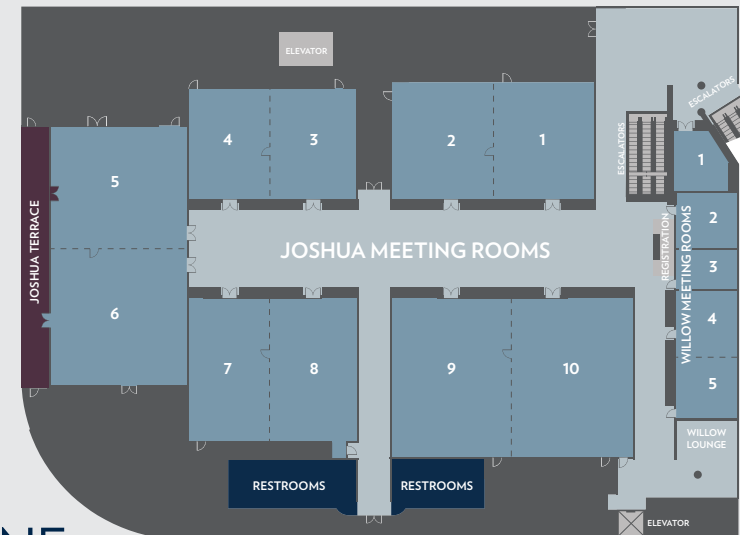

## LEVEL ONE

- Joshua Meeting Rooms
- Joshua Terrace
- Willow Meeting Rooms
- Willow Lounge



## LEVEL TWO

- Mariposa Ballroom
- Cypress Executive Lounge
- Outdoor Terrace

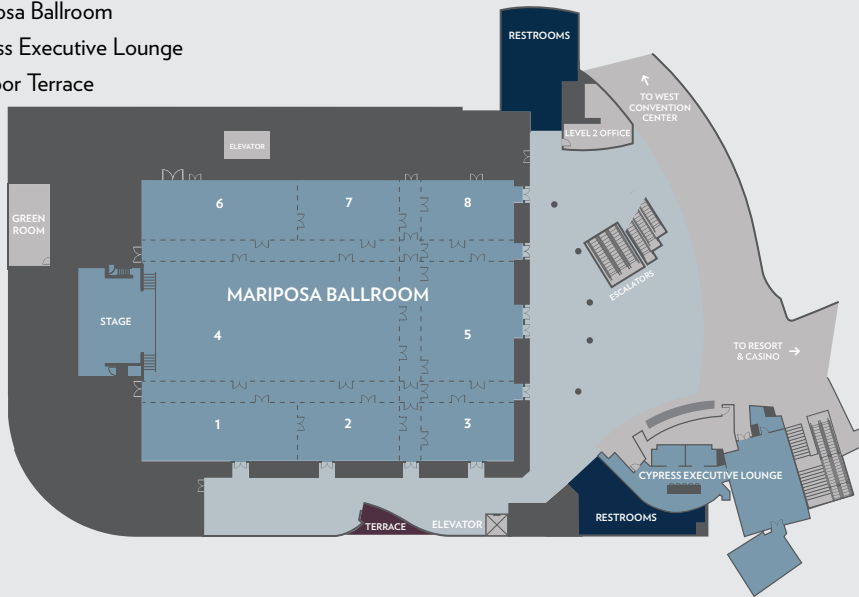

Level Two Pre-Function Space

## LEVEL TWO

The second level will offer a large ballroom as well as naturally lit pre-function spaces connecting to ARIA's existing convention center.

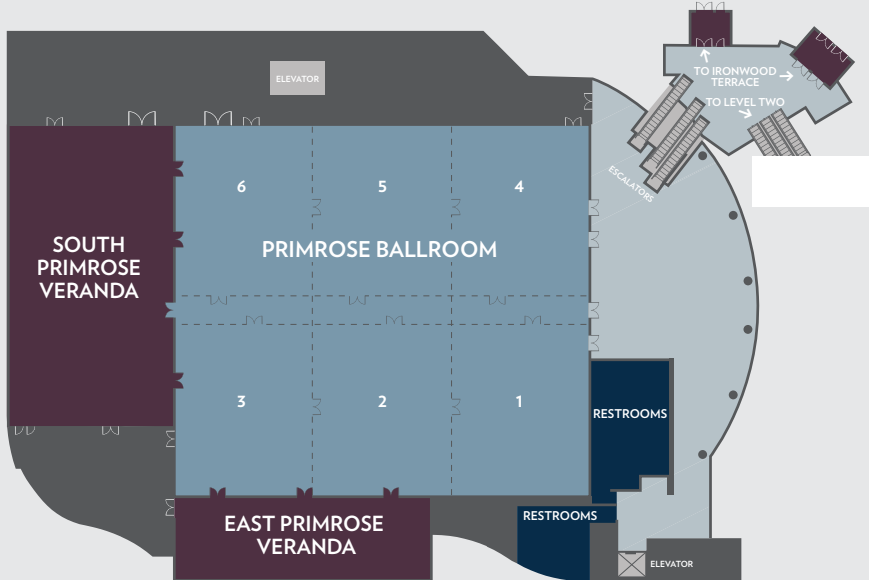

## LEVEL THREE

- Primrose Ballroom
- South and East Primrose Verandas



Level Three Veranda

## LEVEL THREE

The facility's top floor is set to become one of Las Vegas' most unique meeting venues as it complements a vast ballroom with two striking outdoor patios, accommodating receptions for up to 2,000 guests.

*ARIA's East Convention space is expected to be complete in early 2018.*

Level Two, Cypress Executive Lounge



Conference Room



Pantry



Lounge

Aria®

MEETINGS@ARIA.COM  
866.718.2489 • 702.590.7171